

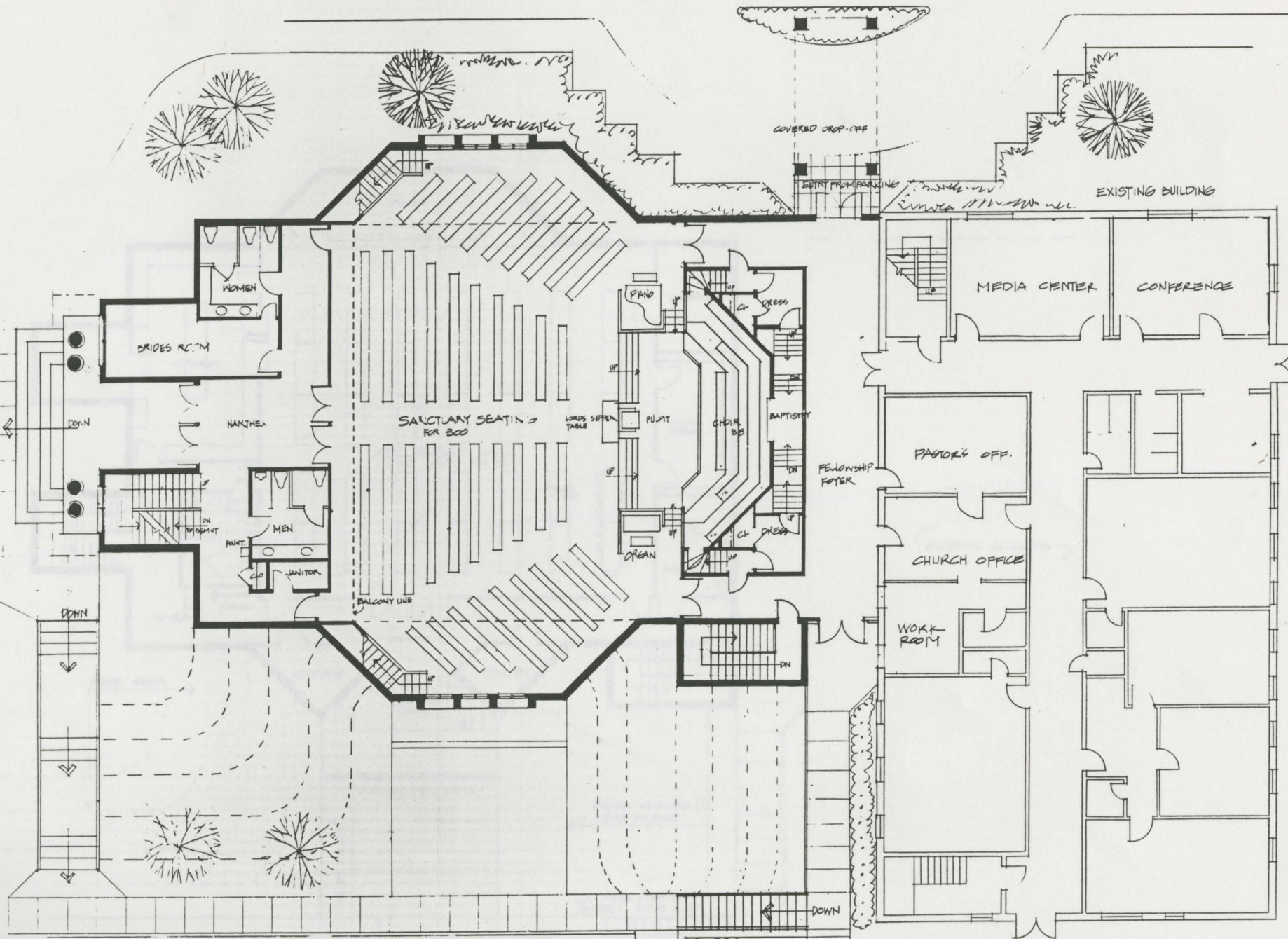

FRONT ELEVATION

HIGHLAND PARK BAPTIST CHURCH

MT. AIRY, NORTH CAROLINA



MAIN FLOOR PLAN

1957 AS SHOWN AREA

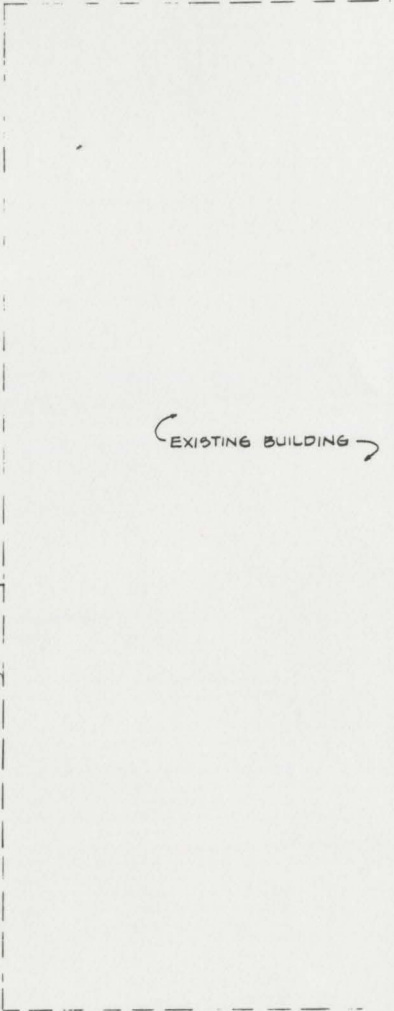
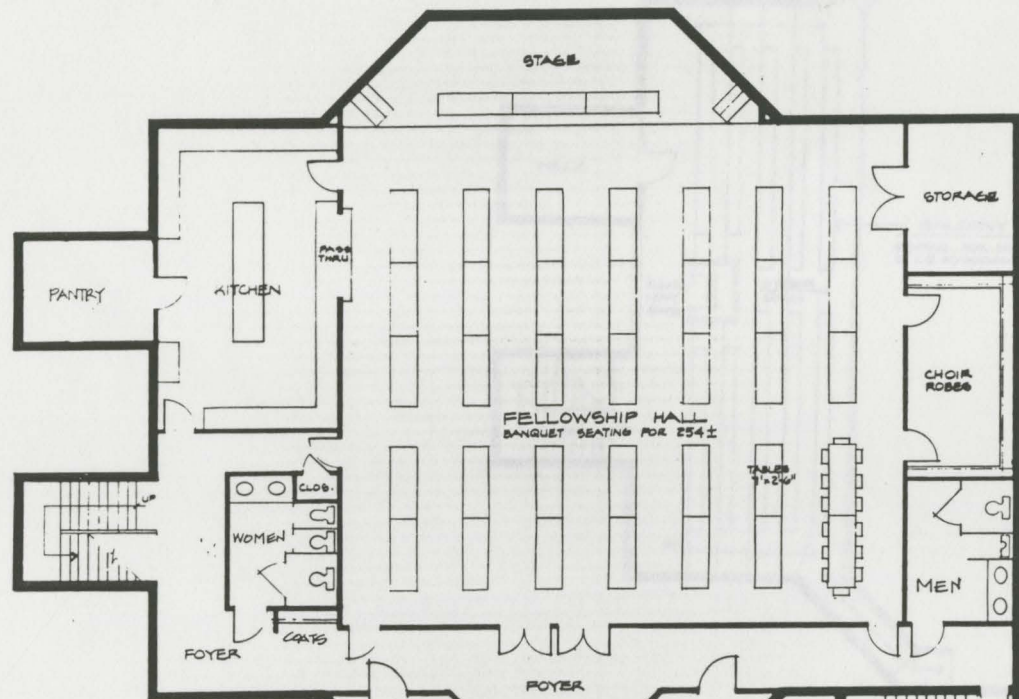

GRADE SLOPE →

↓

STORAGE

COVERED AREA

SLOPE 1/8" MAX.

FLOOR DRAINAGE GRATE

MEN. RM

GRADE TO SLOPE 1/8" APPROX 60' SLOPE ←

CONCRETE STEPS & HANDRAIL ALONG SLOPE

RET. WALL ALONG SLOPE W/ RAILINGS

LOWER LEVEL FLOOR PLAN

SCALE: 1/8" = 1'-0" • 5492 S.F. NEW AREA

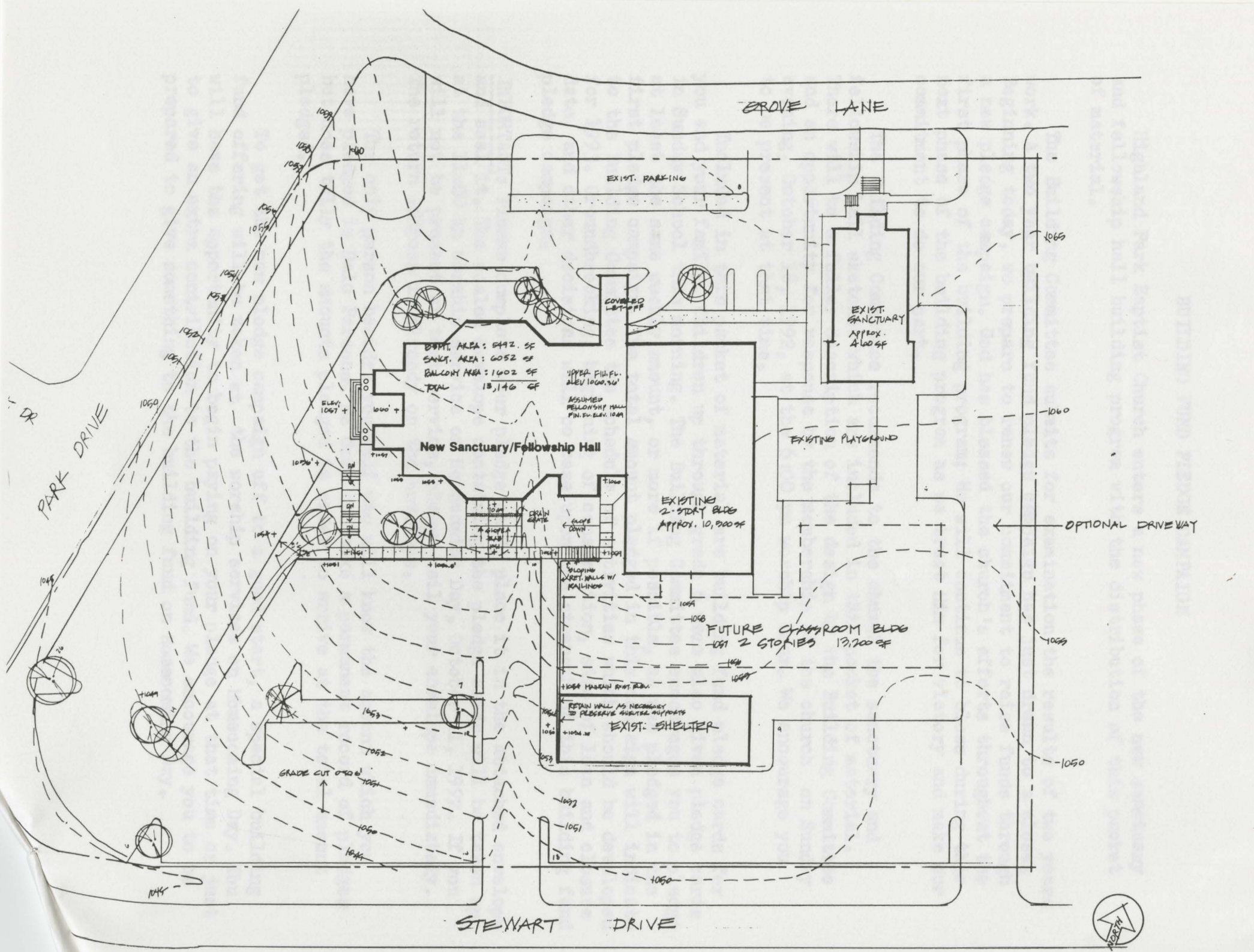

EROVE LANE

EXIST. PARKING

EXIST. SANCTUARY
APPROX.
4,100 SF

BUILT AREA: 5442 SF
SANCT. AREA: 6052 SF
BALCONY AREA: 1602 SF
TOTAL 13,146 SF

UPPER FIN. FL.
ELEV. 1000.50'
ASSUMED FELLOWSHIP HALL
FIN. ELEV. 1049

New Sanctuary/Fellowship Hall

EXISTING PLAYGROUND

EXISTING
2-STORY BLDG
APPROX. 10,500 SF

OPTIONAL DRIVEWAY

FUTURE CLASSROOM BLDG
- 2 STORIES 13,200 SF

EXIST. SHELTER

PARK DRIVE

STEWART DRIVE



BUILDING FUND PLEDGE CAMPAIGN

Highland Park Baptist Church enters a new phase of the new sanctuary and fellowship hall building program with the distribution of this packet of material.

The Building Committee submits for examination the results of two years work. A two year building fund pledge campaign has just drawn to a close. Beginning today, we prepare to renew our commitment to raise funds through a new pledge campaign. God has blessed the church's efforts throughout the first phase of the building program; He will continue to bless during this next phase of the building program as we trust Him for victory and make our commitment to do our part.

The Building Committee recommends to the church the sanctuary and fellowship hall sketches which are included in this packet of material. There will be a fuller description of the design by the Building Committee and an opportunity for response by the membership of the church on Sunday evening, October 18, 1992, at the 6:00 pm worship hour. We encourage you to be present at that time.

Included in this packet of material are building fund pledge cards for you and your family. Children up through grade 6 were also given pledge cards in Sunday School this morning. The Building Committee encourages you to pledge at least the same weekly amount, or more if possible, as was pledged in the first pledge campaign. The total amount pledged in this campaign will indicate to the Building Committee the schedule of activities which should be developed for 1993. Groundbreaking, beginning of construction, size of loan and closure date, and other decisions will be base upon the strength of this building fund pledge campaign.

IMPORTANT: Please complete your pledge card, place it in the attached envelope and seal it. The sealed envelope containing the pledge cards will be taken up at the 11:00 am worship service on Homecoming Day, October 11, 1992. If you will not be present at that service, please mail your envelope immediately. The return address is already on the envelope.

The only person besides yourself who will know the amount which you have pledged is Dale Parsons. He does not make a permanent record of pledges but does tally the amounts pledged in order to arrive at the total amount pledged.

To get the new pledge campaign off to a good start, a special building fund offering will be taken at the worship services on Homecoming Day. You will have the opportunity to begin paying on your pledge at that time or just to give an extra contribution to the building fund. We encourage you to be prepared to give something to the building fund on Homecoming Day.